

# Maria Chapman Middle School School Committee Update

OCTOBER 18, 2018

Town of Weymouth

# PROJECT DESIGN TIMELINE

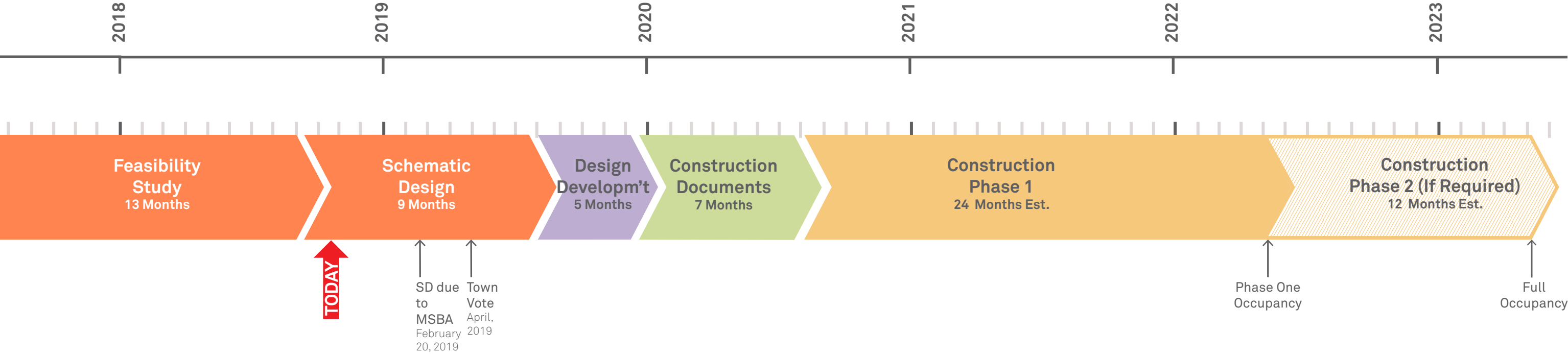



# DISTRICT EDUCATION PLAN

## Key Points

- Reduce Transitions
- Improve communication and collaboration between staff and families
- Improve technology infrastructure and resources to access digital literacy standards
- Foster team teaching and learning through small learning communities
- Expand opportunities and access to electives
- Support feeder CTE program for Weymouth High School with labs and shops
- Provide Wrap-Around Services for students and their families
- Provide full day kindergarten

## Key Spaces

- 6 Exploratory Labs (Computer Tech., Broadcasting, STEM, Project Based Learning, Wood Shop, Culinary)
- Wrap-Around Services connected to school medical suite
- Academic Support Programs (Therapeutic Learning Center, Intensive Resource Rooms, Life Skills, Language Based Learning Disabilities & Speech and Language)
- Auditorium
- Small Group Rooms
- Project Areas
- Core Academic Classrooms
- Theater Arts



# CLASSROOM TEAMS BY GRADE

## SIXTH GRADE

11 TEAMS

### TEAM 6a

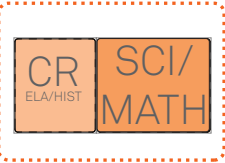

### TEAM 6b

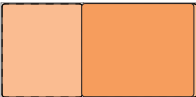

### TEAM 6c



### TEAM 6d

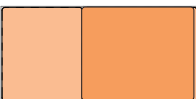

### TEAM 6e

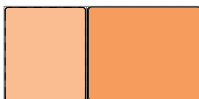

### TEAM 6f

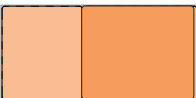

### TEAM 6g

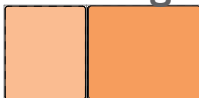

### TEAM 6h

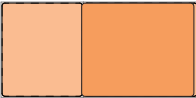

### TEAM 6i

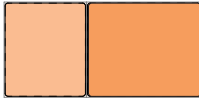

### TEAM 6j

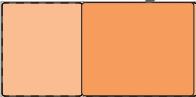

### TEAM 6k



## SEVENTH GRADE

5 TEAMS - 4 LARGE, 1 SMALL

### TEAM 7a

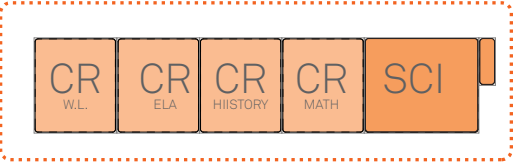

### TEAM 7b

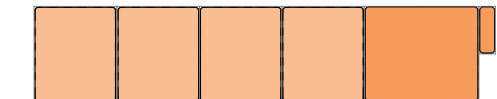

### TEAM 7c

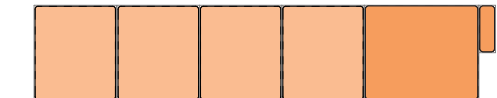

### TEAM 7d

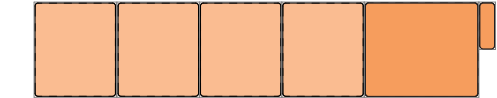

### TEAM 7e

SMALL TEAM LEARNERS



## EIGHTH GRADE

5 TEAMS - 4 LARGE, 1 SMALL

### TEAM 8a

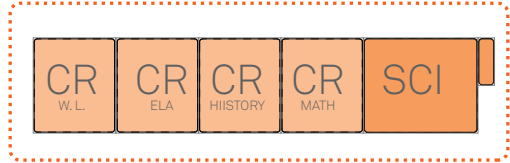

### TEAM 8b

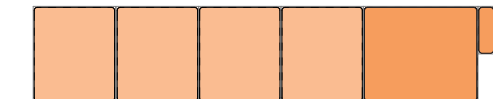

### TEAM 8c

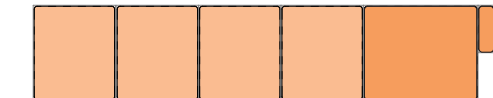

### TEAM 8d

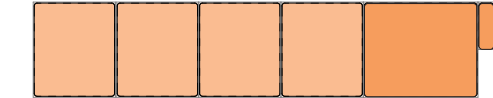

### TEAM 8e

SMALL TEAM LEARNERS







# SITE SELECTION

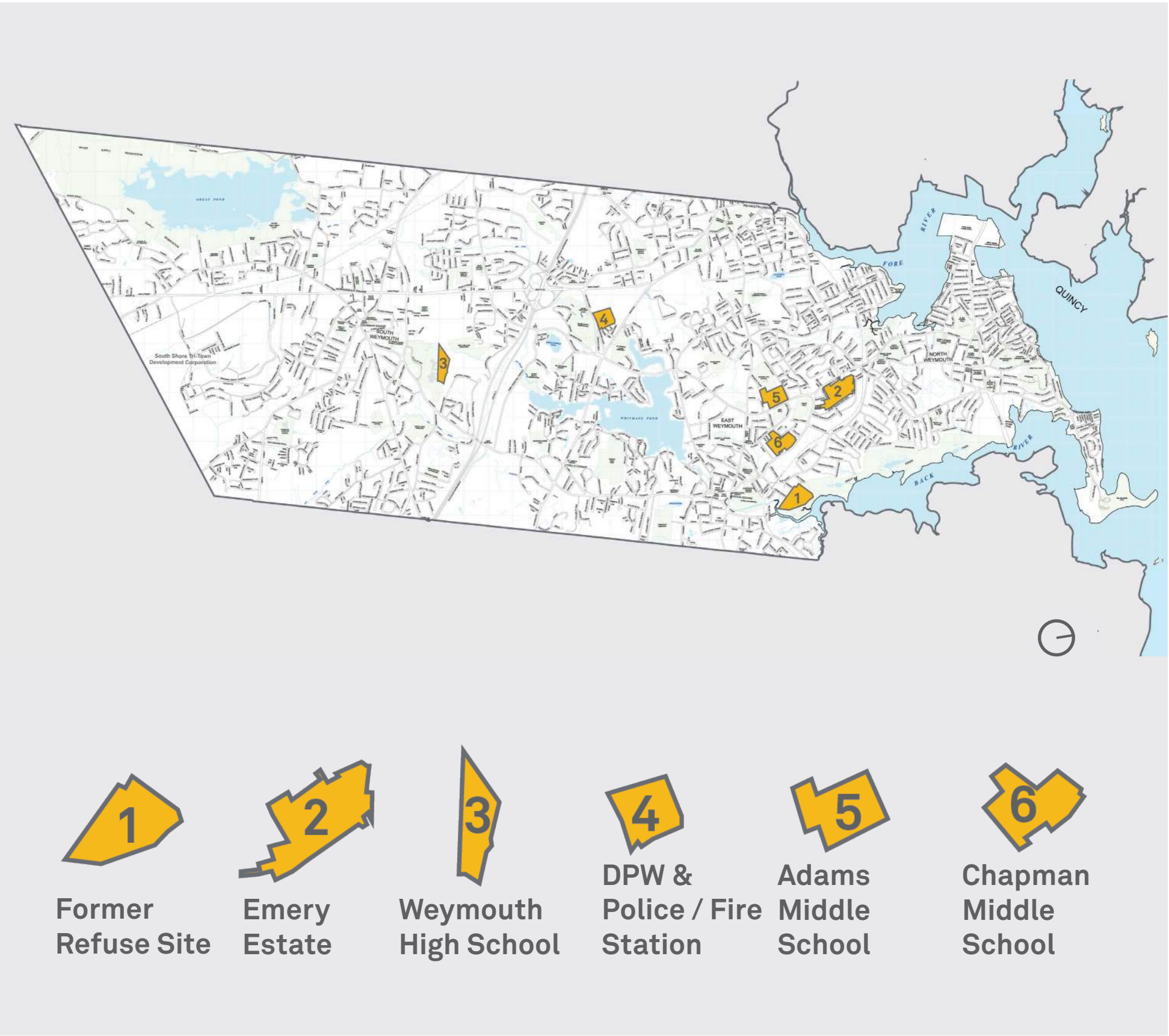

Adams Site Plan



Chapman Site Plan





# EXISTING CONDITIONS - SITE PLAN



## Diagram Key

- Bus
- Parent
- Emergency
- Staff
- Accessible Entry
- Inaccessible Entry
- Door
- Parking Lot
- Courtyard
- Rain Garden
- Outdoor Terrace
- Area of Exposed Ledge
- Significant Tree Massing



# THE TIME HAS COME...



Built in 1961, the existing building does not:

- support today's educational program.
- meet current building codes.

Due to the building's inflexible structure and circuitous floor plan, renovation would be expensive, while still not:

- creating appropriate spaces for education today.
- resolving all of the building's deficiencies.





# CRITICAL RENOVATION ISSUES

## Structural Limits and Deficiencies:

- inflexible concrete structure
- low floor to floor height
- structure compromises thermal envelope

## Limited technology opportunities/upgrades

## Inefficient and inoperable systems (e.g. mechanical)

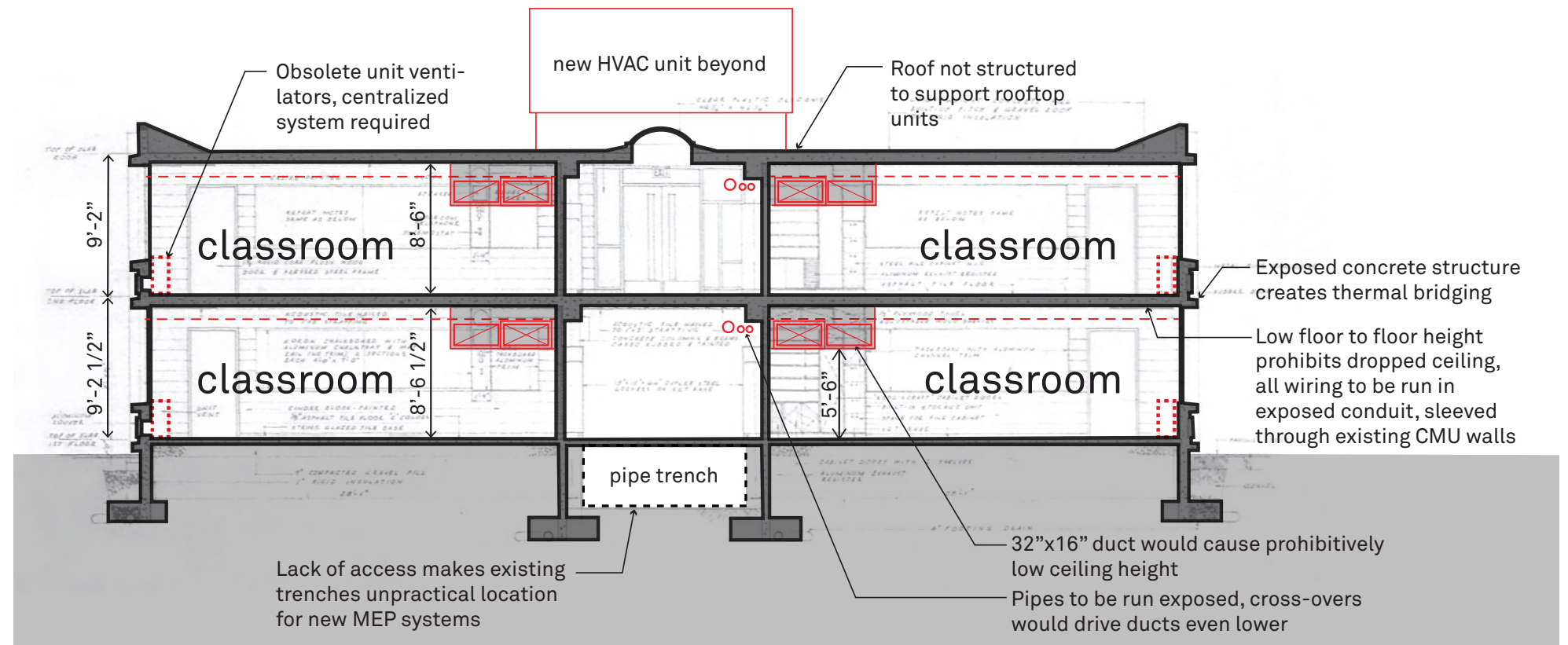





# CRITICAL RENOVATION ISSUES

## Accessibility Challenges & Limitations:

- many level changes
- each elevator does not connect all levels
- steep, long ramp
- poor wayfinding

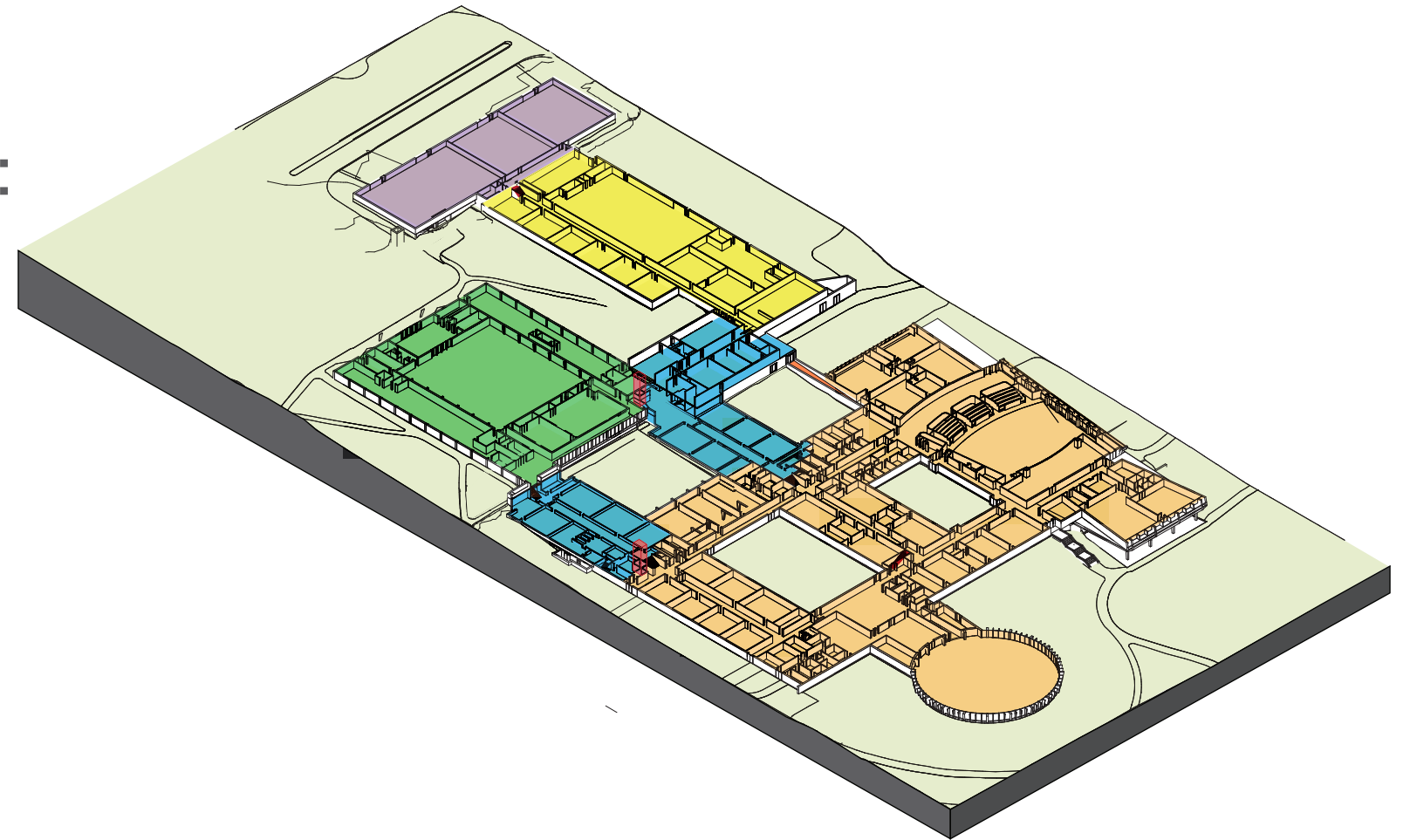

Significant portions of the building are not suited for renovation.

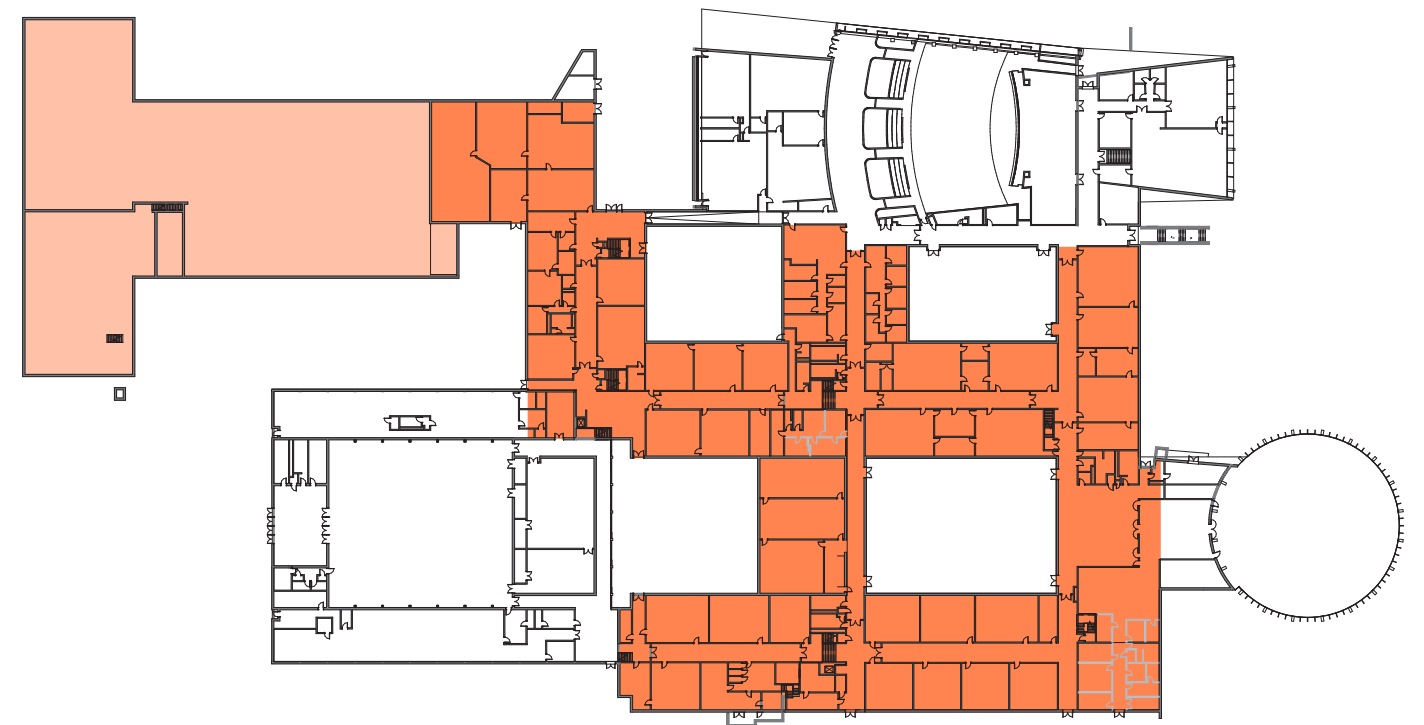



# DESIGN OPTIONS

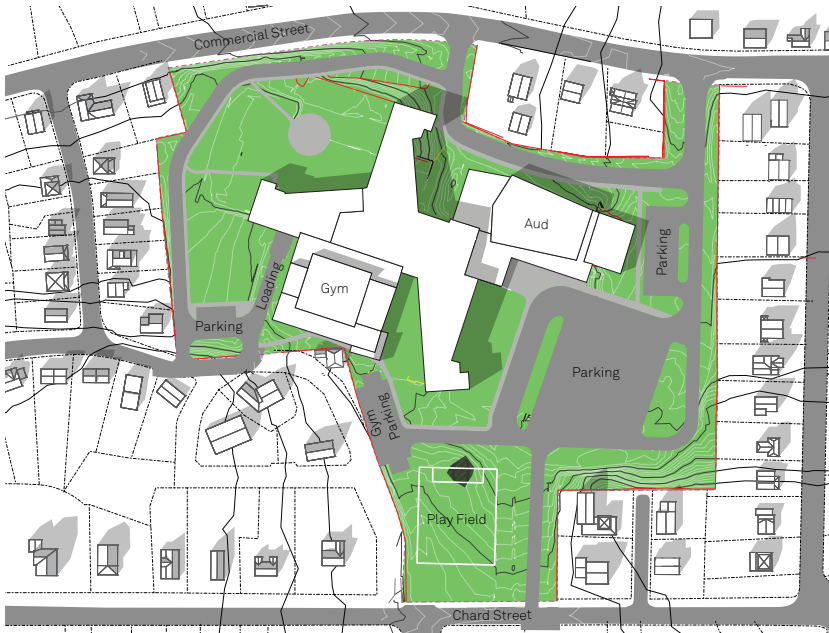

**Option B1**

Renovation / Addition

\$117,000,000 - \$129,000,000 ETPC



**Option C1**

Renovation / Addition

\$143,000,000 - \$158,000,000 ETPC

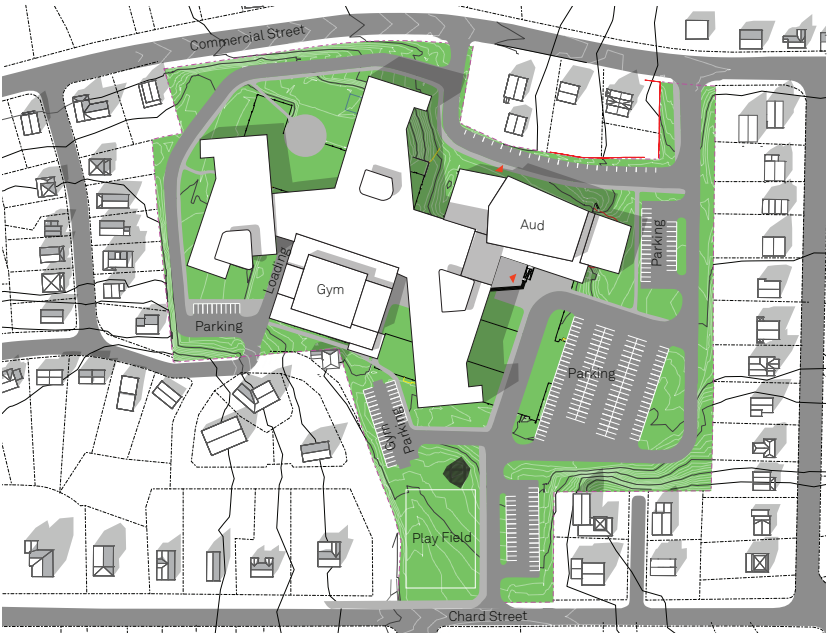

**Option D1**

Renovation / Addition

\$154,000,000 - \$170,000,000 ETPC



**Option B2**

New Construction

\$119,000,000 - \$132,000,000 ETPC

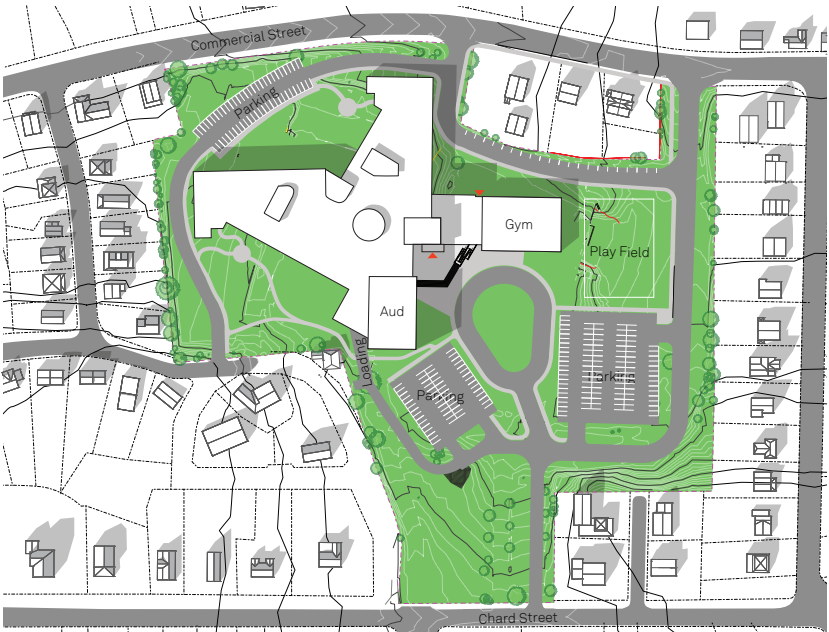

**Option C2**

New Construction

\$146,000,000 - \$162,000,000 ETPC



**Option D2**

New Construction

\$157,000,000 - \$174,000,000 ETPC





# FINAL OPTIONS COMPARISON

OPTION	ENROLLMENT	PROJECT COST	WEYMOUTH COST	MSBA FUNDING	EDUCATIONAL EQUITY	THEATER FEATURES	GYM SIZE	OTHER PROJECTS
C1 ADDITION / RENOVATION	Students: 1230 Grades 5-8	\$143M-\$158M	\$89M-\$98M	\$54M-\$60M	<div>No Equity</div>	<div>Partial</div>	<div>850</div>	Future Middle School Project
C1.1 NEW AUDITORIUM	Students: 1230 Grades 5-8	\$146M-\$161M	\$92M-\$101M	\$54M-\$60M	<div>No Equity</div>	<div>Full</div>	<div>Full</div>	Future Middle School Project
C2 NEW CONSTRUCTION	Students: 1230 Grades 5-8	\$146M-\$162M	\$92M-\$102M	\$54M-\$60M	<div>No Equity</div>	<div>Full</div>	<div>200</div>	Future Middle School Project
D1 ADDITION / RENOVATION	Students: 1470 Grades 6-8	\$154M-\$170M	\$100M-\$111M	\$54M-\$60M	<div>Full Equity</div>	<div>Partial</div>	<div>850</div>	Adam's Conversion \$6.3M
D1.1 NEW AUDITORIUM	Students: 1470 Grades 6-8	\$157M-\$174M	\$103M-\$114M	\$54M-\$60M	<div>Full Equity</div>	<div>Full</div>	<div>Full</div>	Adam's Conversion \$6.3M
D2 NEW CONSTRUCTION	Students: 1470 Grades 6-8	\$157M-\$174M	\$103M-\$114M	\$54M-\$60M	<div>Full Equity</div>	<div>Full</div>	<div>200</div>	Adam's Conversion \$6.3M



# PREFERRED SOLUTION - SITE PLAN



## Key

Parent Drop Off



Bus Drop Off



Expansion Classrooms



(Provides six (6) additional classrooms, two (2) per grade)







# PREFERRED SOLUTION

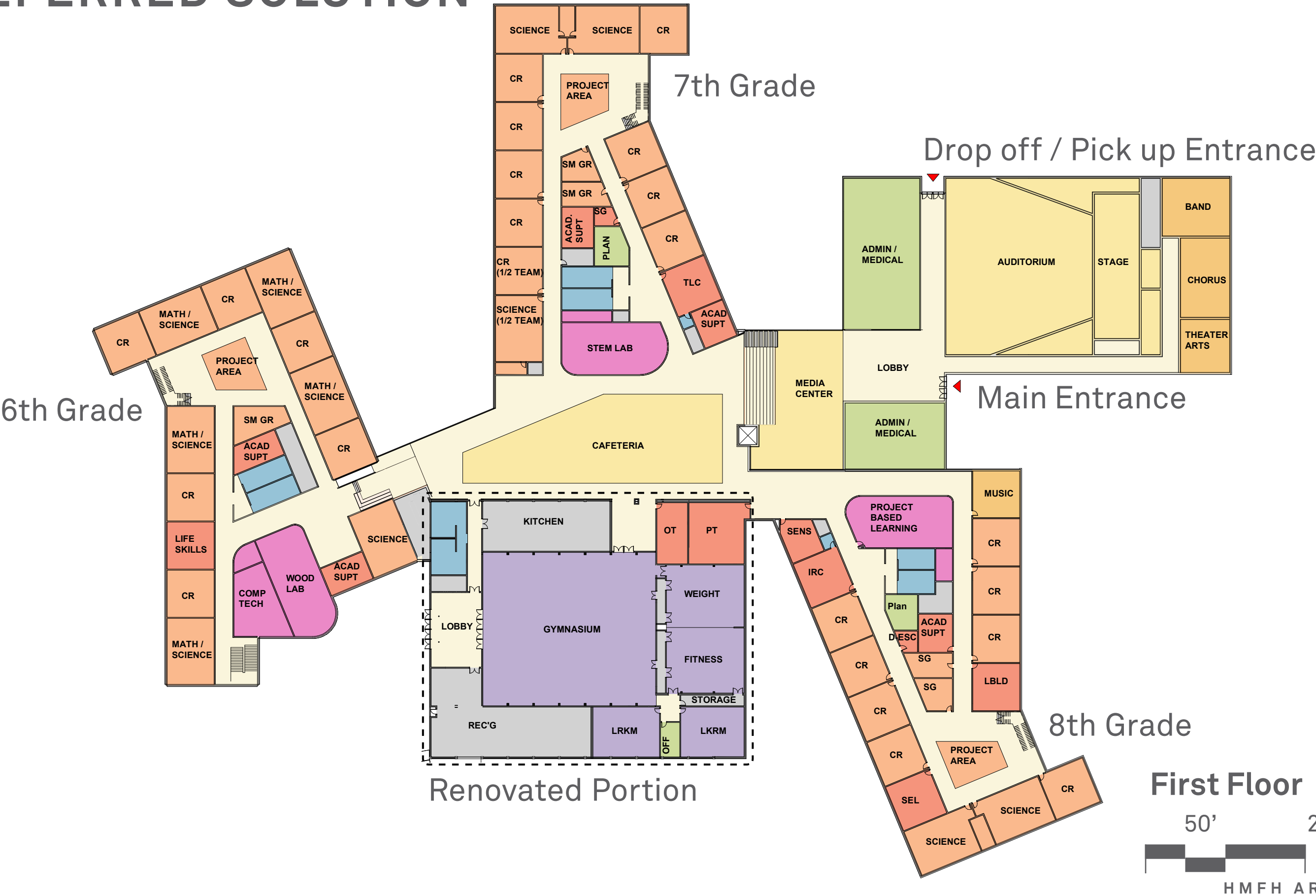

First Floor

50' 200'



HMFH ARCHITECTS





# PREFERRED SOLUTION

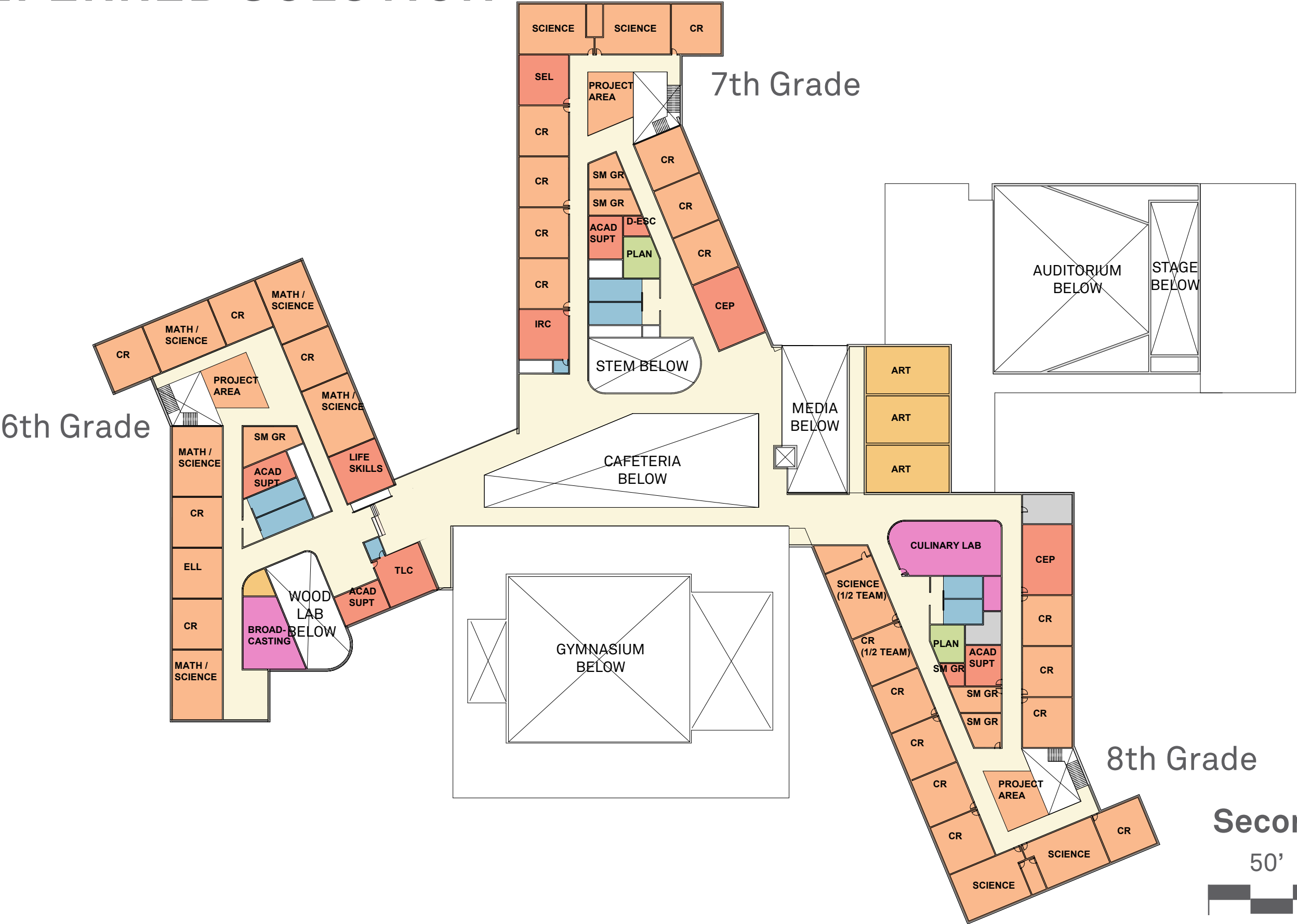



# VARIATIONS FROM MSBA SPACE GUIDELINES

•Core Academic.....	6,625 nsf
•Special Education.....	2,575 nsf
•Art and Music.....	2,355 nsf
•Vocations and Technology.....	1,600 nsf
•Health and Physical Education (renovation).....	12,560 nsf
•Media Center.....	(-4,833 nsf)
•Dining and Food Service.....	(-4,654 nsf)
•Medical.....	50 nsf
•Administration.....	270 nsf
•Added Auditorium & Stage.....	11,100 nsf
•Added Auditorium Storage and Dressing Room.....	1,300 nsf
•Added District Transportation Office and Driver Break Room.....	800 nsf
<b>Total.....</b>	<b>29,748 nsf</b>





# KEY FACTORS IN PREFERRED OPTION

**The Preferred Solution was community driven and selected for the following reasons:**

- Realizes all aspects of districts education plan.
- Optimizes program adjacencies .
- Allows for flexible learning spaces.
- Supports team teaching through spacial organization and adjacencies.
- Allows site to be occupied by students while construction occurs without major disturbance to education delivery.
- Costs the least in the long term, compared to building multiple new schools.
- Increases outdoor program use.
- Reuses existing (larger) gymnasium.



# WHAT IS SUSTAINABILITY AT CHAPMAN MIDDLE SCHOOL?

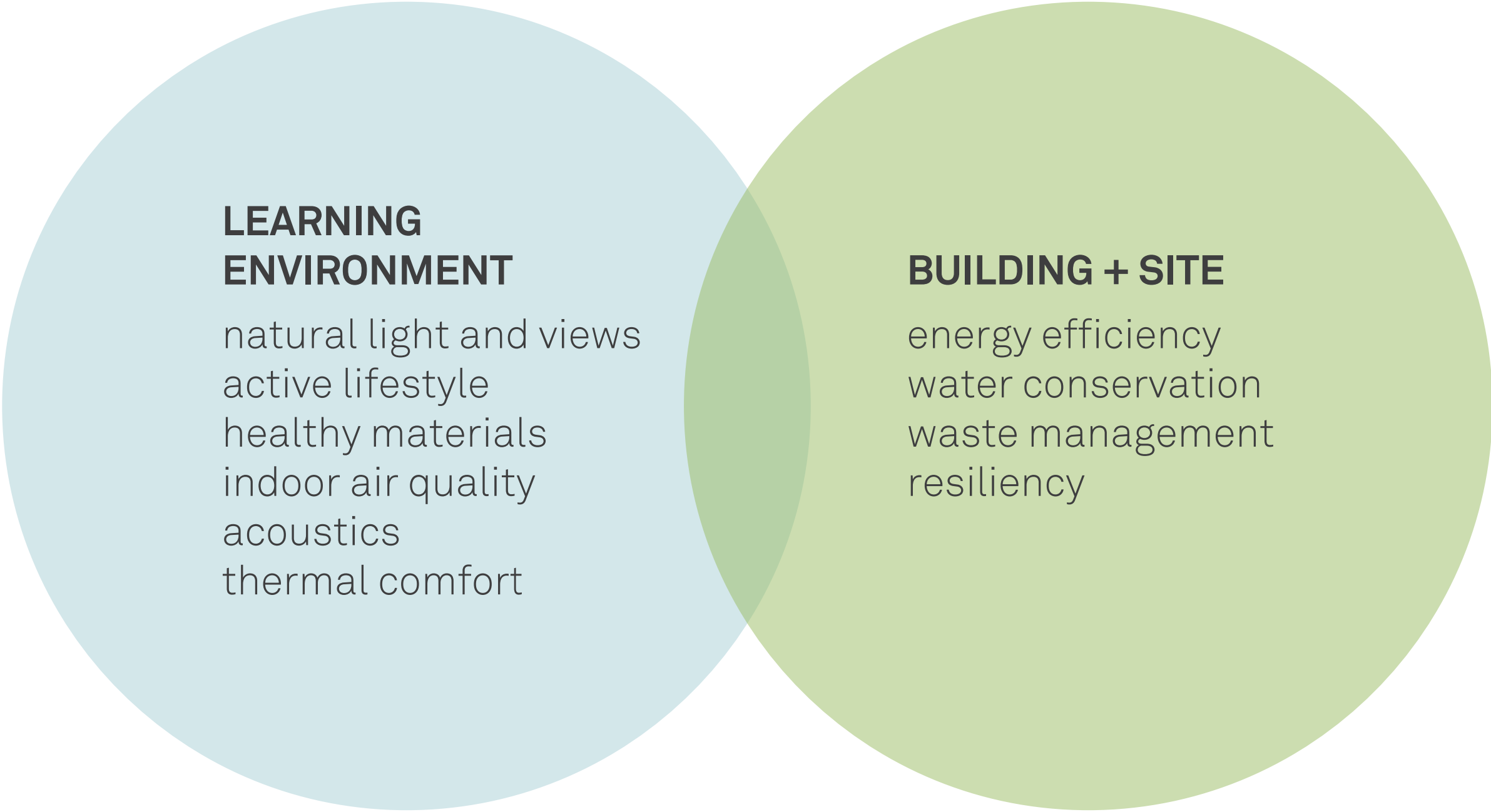



# SUSTAINABILITY CHARETTE

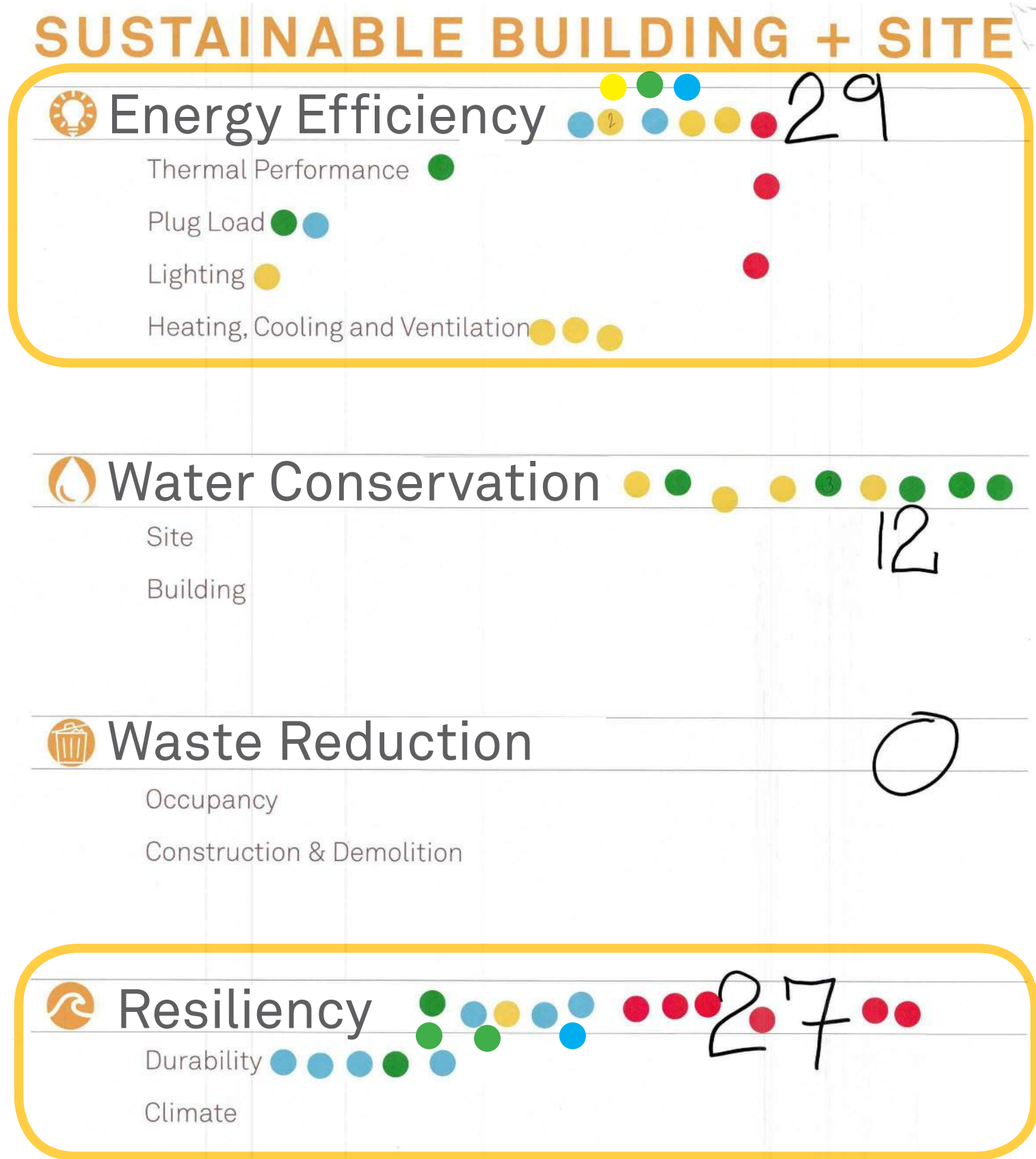
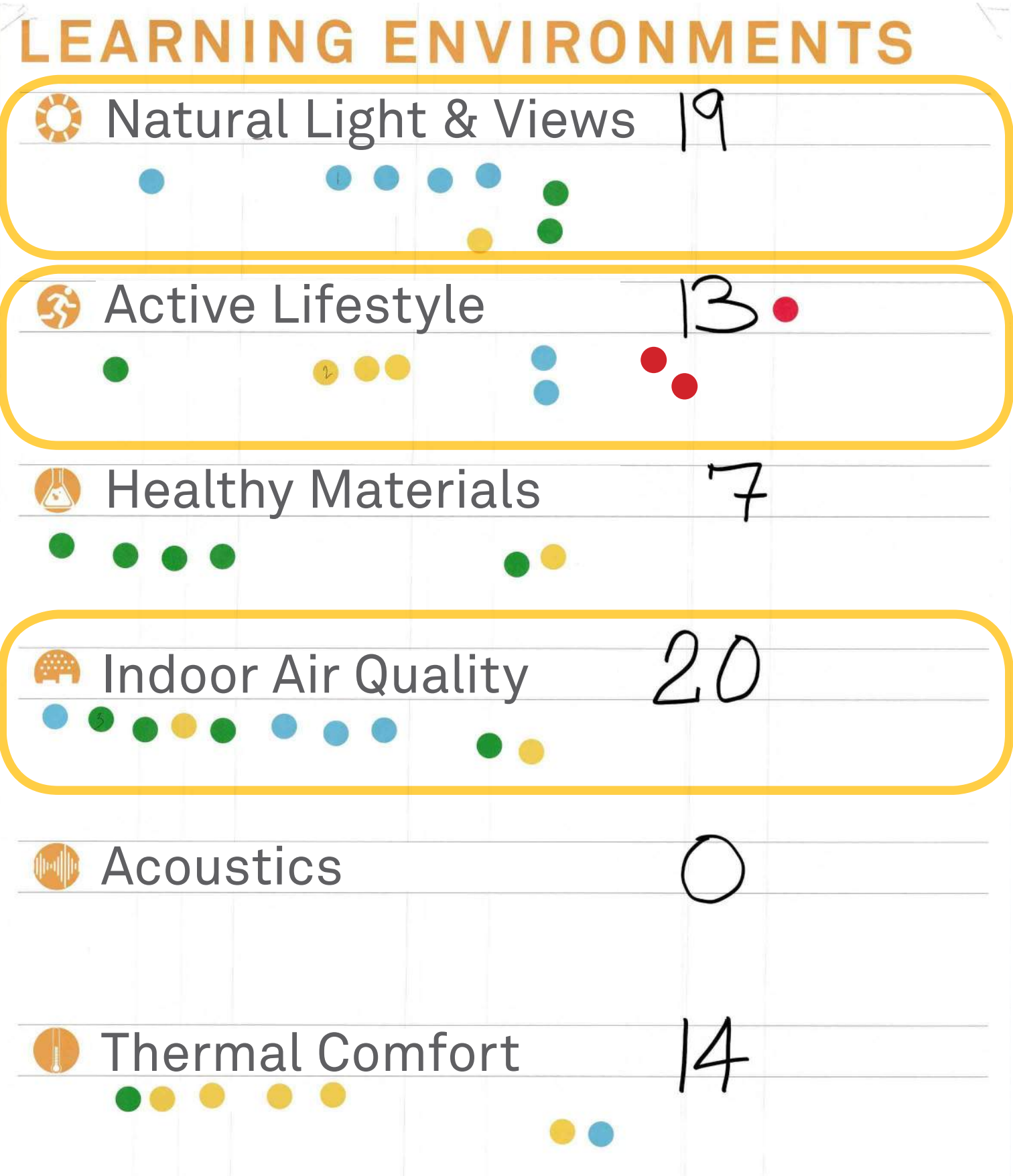





# COMMUNITY SURVEY (668 RESPONDENTS)

The issue of parity was raised during the review of alternatives. How important is it that all middle school students of the same grades receive the same educational experience from the School Building project?

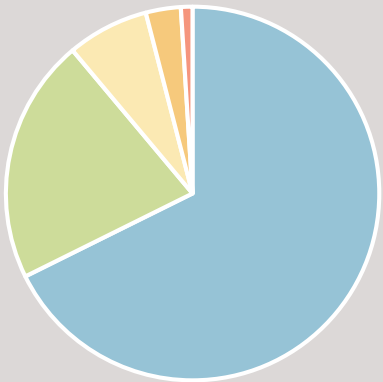

- Extremely Important....67%
- Very Important.....21%
- Somewhat Important.....7%
- Not So Important.....3%
- Not at all Important.....1%

How important is a solution that reduces the amount of transitions between schools?

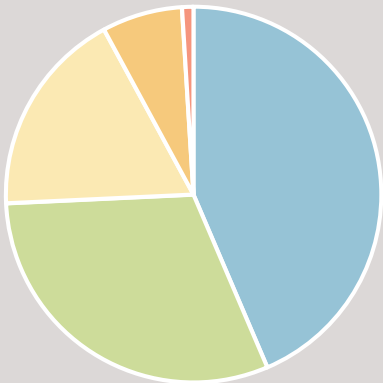

- Extremely Important....44%
- Very Important.....31%
- Somewhat Important....18%
- Not So Important.....7%
- Not at all Important.....<1%

How important is a solution that also helps to address the District’s ability to provide All Day Kindergarten?

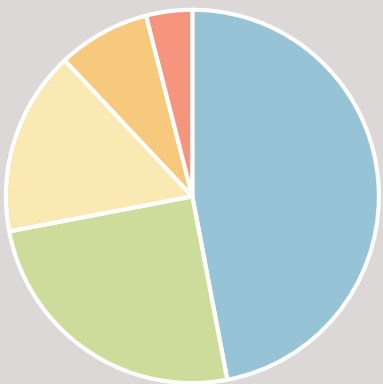

- Extremely Important....47%
- Very Important.....25%
- Somewhat Important....16%
- Not So Important.....8%
- Not at all Important.....4%

The School Building Committee narrowed the viable options to two final designs. Which of the following design alternatives provides the best long-term solution for educating Weymouth middle school children?

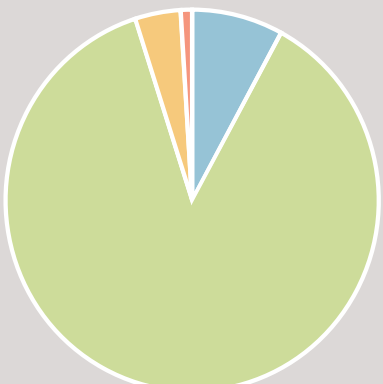

- Option D.....88%
- Option C.....8%
- Another Option.....4%
- I don't support a new Chapman .....<1%



# COMMUNITY OUTREACH PROCESS

## Scheduled Presentations:

- School Committee Update - October 18<sup>th</sup> at 7:00 pm
- Parent Conference Presence:
  - High School – Cafeteria – November 14<sup>th</sup>
  - Adams MS – Library – November 15<sup>th</sup>
  - Chapman MS – Entry – November 27<sup>th</sup>
- Town Council Presentation – December 17<sup>th</sup>
- Presentations to Additional Community Groups in 2019. Stay tuned.



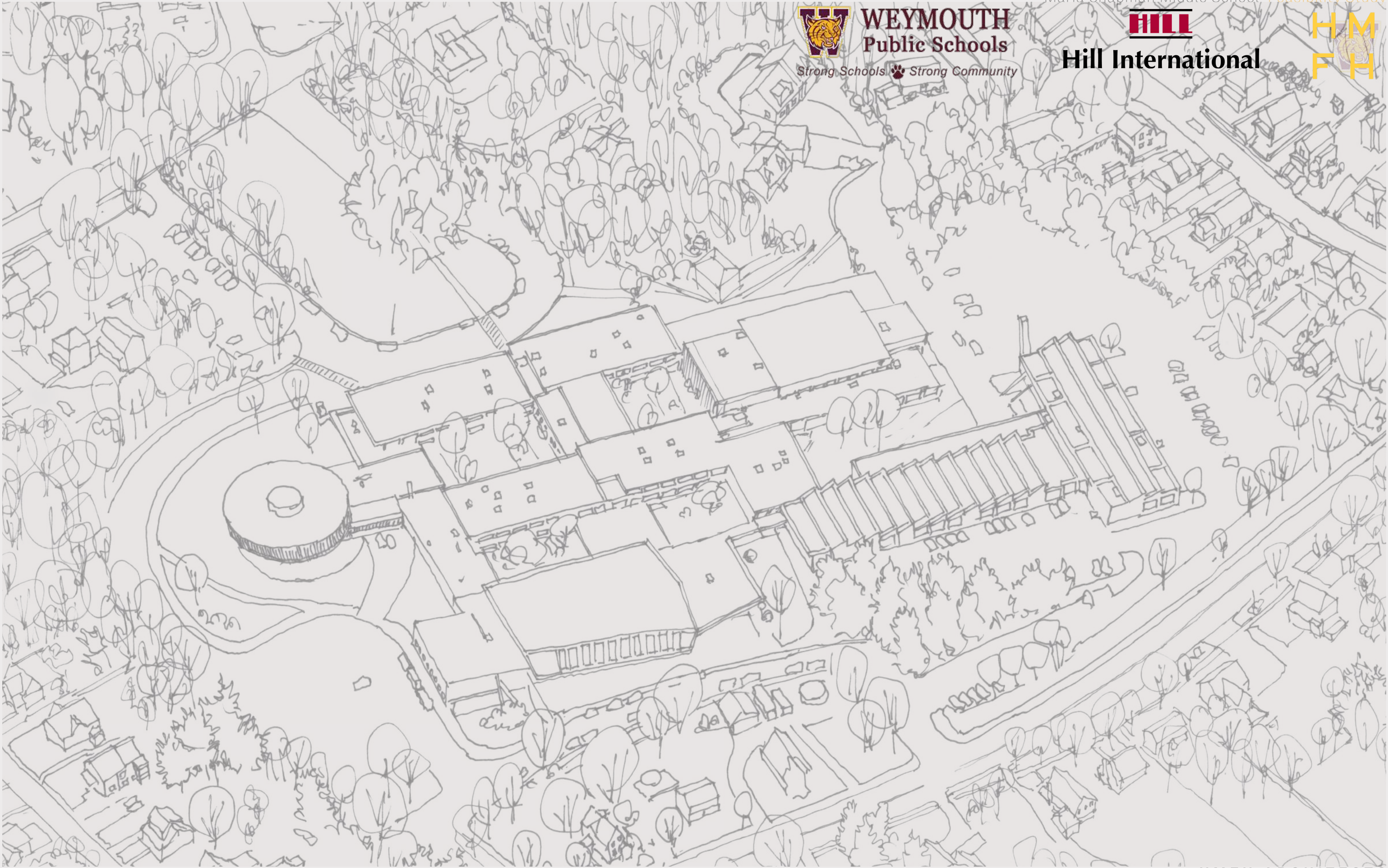

**WEYMOUTH**  
**Public Schools**

Strong Schools  Strong Community



**Hill International**

